

DISCLAIMER: Information shown hereon is a composite of information from various different data sources. Users are warned that the information is provided by the City of Swan in this format as a general resource on the understanding that it is not suitable as a basis for decision making without verification with the original source.

Enter
your note
here

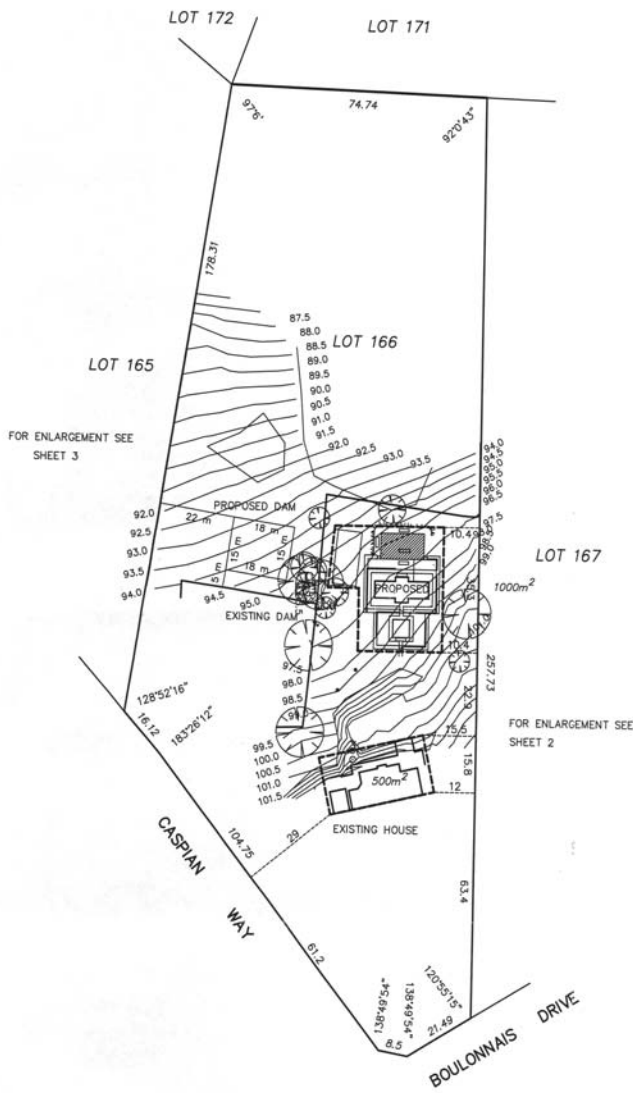

1:4218
Tuesday,
October 31,
2006



STATEWEST SURVEYING & PLANNING

Licensed Surveyors & Town Planners
 Directors B.A.Hunt & R.J.M.Rogers Associates P. Incerli, S O'Hara & L.G. Smith
 Midland House P.O. Box 1377, Midland W.A. 6936 69 Great Northern Highway, Midland
 Telephone (08)9274 3198 Facsimile (08) 9274 3878 Email statewest@statewest.net
 Website <http://www.statewest.net>

**SITE SURVEY PART OF
 LOT 166 CASPIAN WAY
 BRIGADOON**

SCALE	DATE	DRAWN	CHECKED	REFERENCE	SHEET No.
1:1000	28-8-06	T.C.		14056	1