

# PROPOSAL

## SCOPE OF WORK (in addition to asbestos removal + structural scope)

### FLOOR AREA

- Additions: Approx 29m<sup>2</sup>
- Proposed Floor Area: 495m<sup>2</sup>

### OVERALL

#### UPGRADES TO SERVICES + BUILDING COMPLIANCE:

- Mechanical
- Hydraulic
- Electrical
- Security
- Accessibility

#### ADDITIONS:

- External Store, UAT&Shower, Dual Access Airlock, Communications Room
- New External Pergola

#### ALTERATIONS:

- Entry Stairs + Accessibility Ramp
- Access to Foyer via Airlock
- New Furniture Store
- Toilets

#### FIT-OUTS:

- Kitchen
- Lesser Hall
- Cleaners Store + Playgroup Store Room
- Foyer

#### MINOR WORKS:

- Main Hall

#### LEGEND:

- Additions
- Alterations to Building
- Areas to be Fit-Out

Refer Scope of Works for full extent of scope.

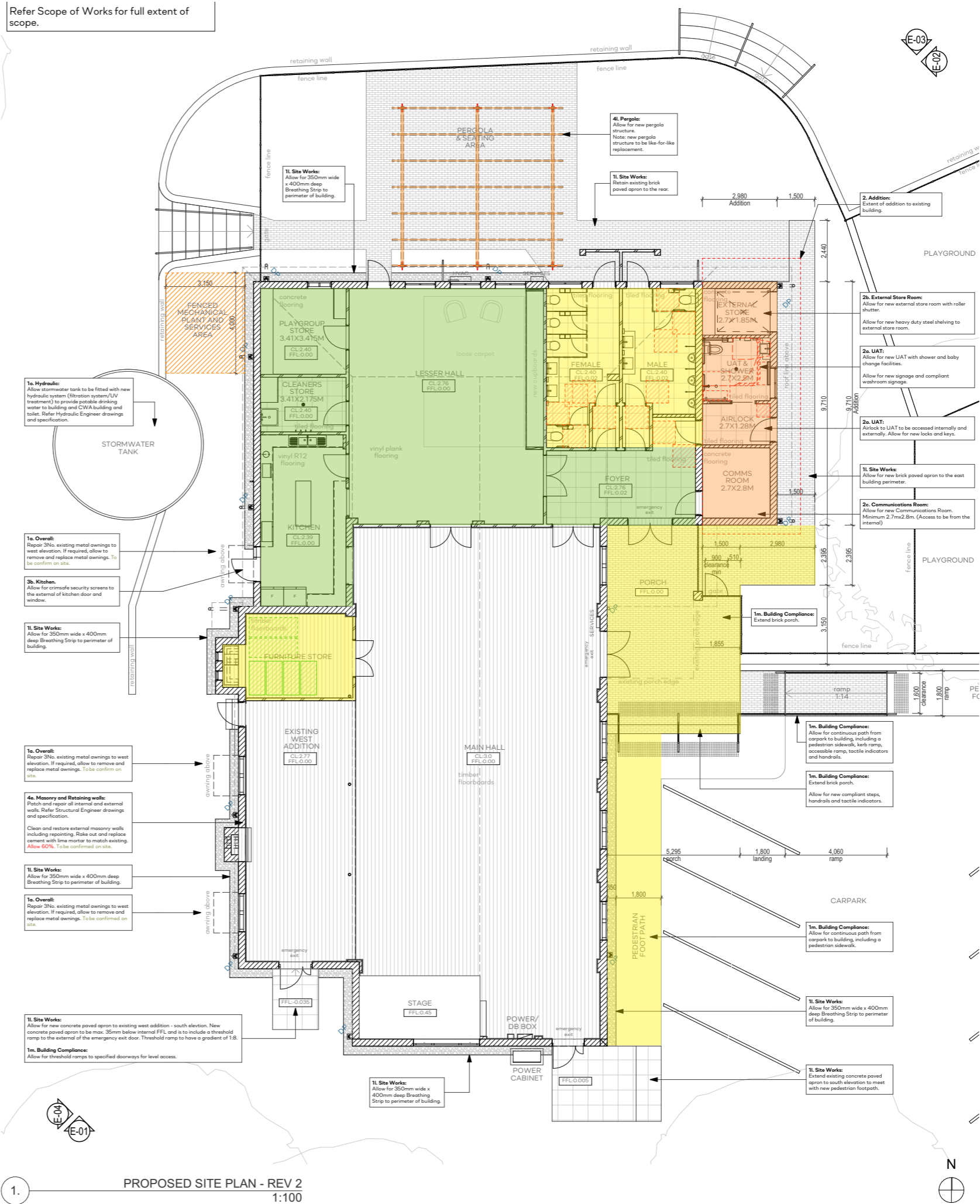



# SCOPE

## ADDITIONS

### FLOOR AREA

- Additions: Approx 29m<sup>2</sup>
- Proposed Floor Area: 495m<sup>2</sup>

## ADDITIONS

- 1 EXTERNAL STORE
- 2 UAT&SHOWER
- 3 DUAL ACCESS AIRLOCK
- 4 COMMUNICATIONS ROOM
- 5 NEW EXTERNAL PERGOLA

### LEGEND:



Refer Scope of Works for full extent of scope.

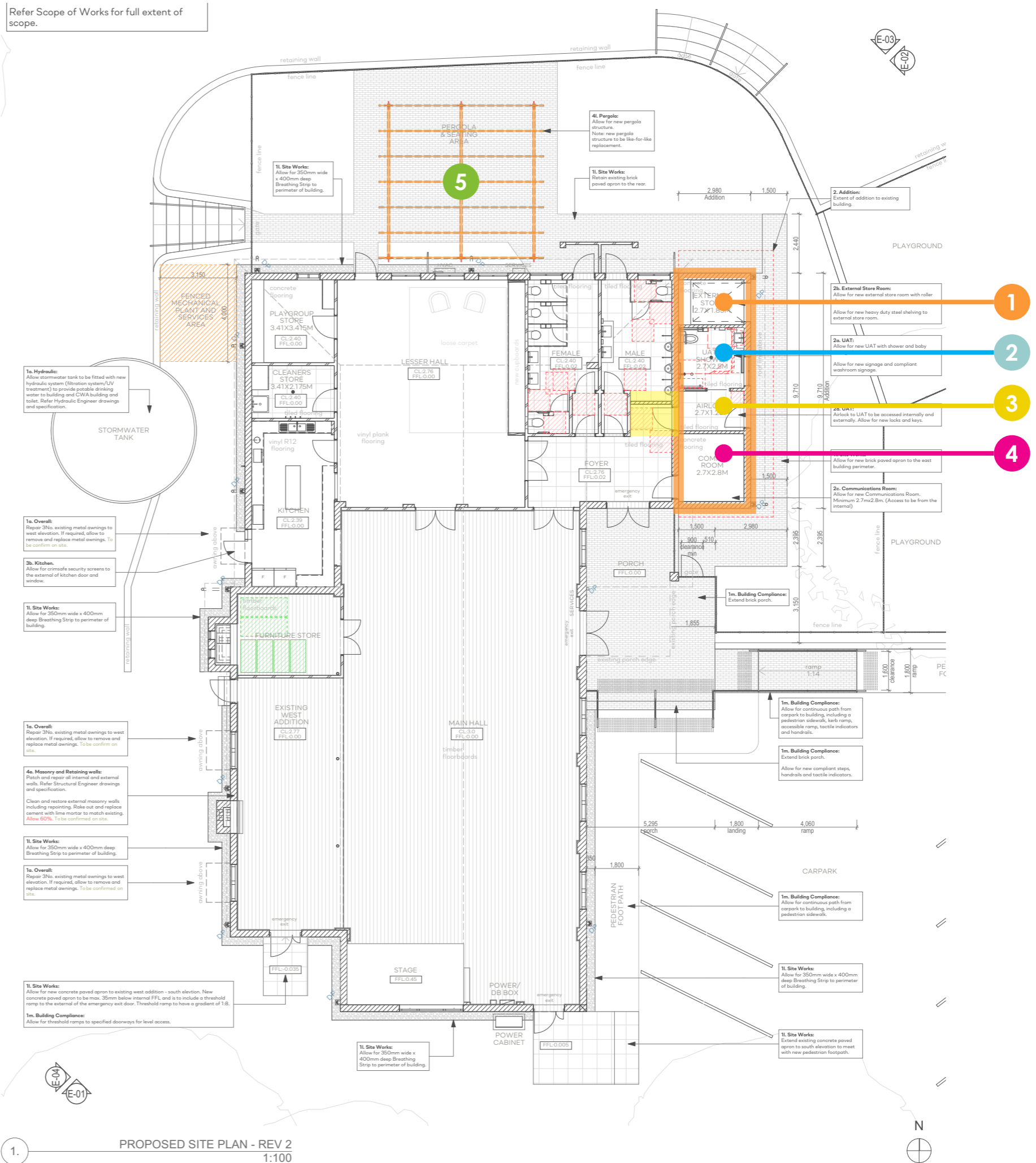



# SCOPE

## FIT-OUTS + MINOR WORK

### FULL FIT-OUT: INCLUDING:

New flooring, ceiling, surface finishes, fittings and fixtures.

- 1 KITCHEN
- 2 LESSER HALL
- 3 CLEANERS STORE
- 4 PLAYGROUP STORE ROOM
- 5 FOYER

### MINOR WORKS:

- 6 MAIN HALL
  - Repair floorboards
  - New Ceiling
  - New Picture Hanging System
  - Paint Works

### LEGEND:

AREAS TO BE FIT-OUT

Refer Scope of Works for full extent of scope.

