

Disclaimer:
 The City makes every attempt to keep its published records up to date; however the subject document may have been superseded by a more recently approved document.

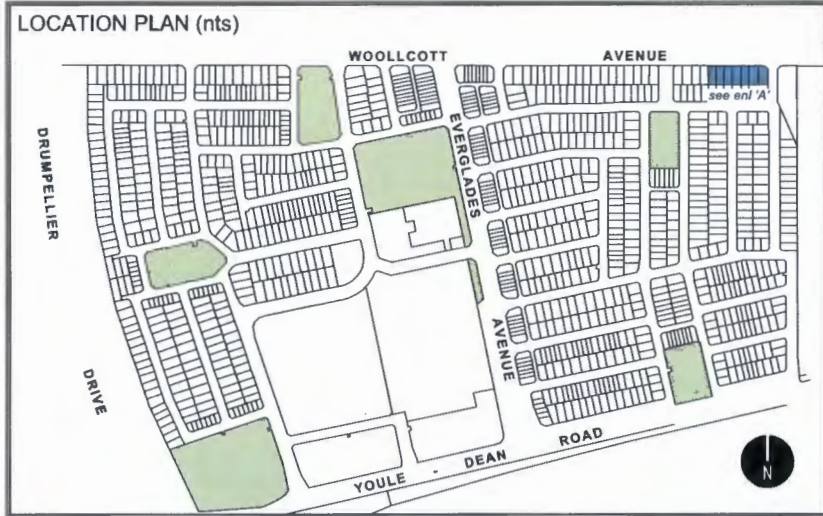

Whiteman Edge

LOCAL DEVELOPMENT PLAN No. 7



PROVISIONS

1. Unless provided for below, the provisions of the City of Swan Local Planning Scheme No. 17, the Brabham Local Structure Plan 1C and the Residential Design Codes apply.
2. Consultation with adjoining or other landowners to achieve a variation to the provisions of the R-Codes or R-MD Codes in accordance with this LDP is not required.
3. Lots 101 - 107 are partly within a Western Power easement as shown on the plan. A 7.3m front setback applies in accordance with the easement. Reductions to this setback are not permitted, including where a compensating open space area behind the setback line is provided.

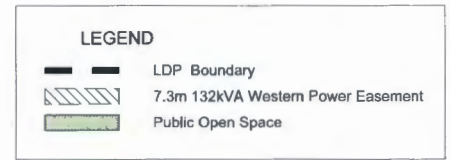

ENDORSEMENT TABLE

Manager Planning Services City of Swan Date: 13/08/2021

This Local Development Plan has been adopted by Council and signed by the Manager / Coordinator - Statutory Planning.

