

Local Development Plan R-Code Variations

- 1 GENERAL**
 - a) The provisions of the City of Swan Local Planning Scheme No. 17 (LSP17), including Local Planning Policy 11 – Variations to deemed-to-comply requirements of the R-Codes Medium Density Single House Development Standards, and the 'R30 and 'R40' Residential Design Codes apply unless varied by this Local Development Plan (LDP).
 - b) Where there is conflict between the requirements of LSP17 and/or the R-Codes with this LDP, the provisions of this LDP prevail to the extent of any inconsistency.
 - c) Minor variations to the requirements of this LDP may be approved by the City of Swan.
- 2 SITE PLANNING AND DESIGN**
 - a) All garages and carports shall be constructed within the designated areas where marked on the LDP.
 - b) Dwellings to have habitable rooms and/or windows facing the primary street.
- 3 BIN STORAGE AND COLLECTION**
 - a) All laneway lots are required to have a bin collection area, of a minimum dimension of 1.5m wide x 1m deep, abutting the rear laneway, whilst taking into account adjacent fences, gutters and built form.
 - b) Lots 110 and 111 to have rubbish collection provided from nearby bin pad located within Elderberry Drive.

Legend

- | | |
|----------------------------------|--|
| Extent of Local Development Plan | No Vehicle Access |
| R30 Subject Lots | Designated Garage Location |
| R40 Subject Lots | Dwelling Orientation |
| | Footpath |
| | Bin Pad for Lots 110 & 111 (exact location subject to detailed design) |

CITY OF SWAN
Planning Information
 ECM Doc Set ID: 4339124
 Approval Date: 5/12/2017

Disclaimer:
 The City makes every attempt to keep its published records up to date; however the subject document may have been superseded by a more recently approved document.

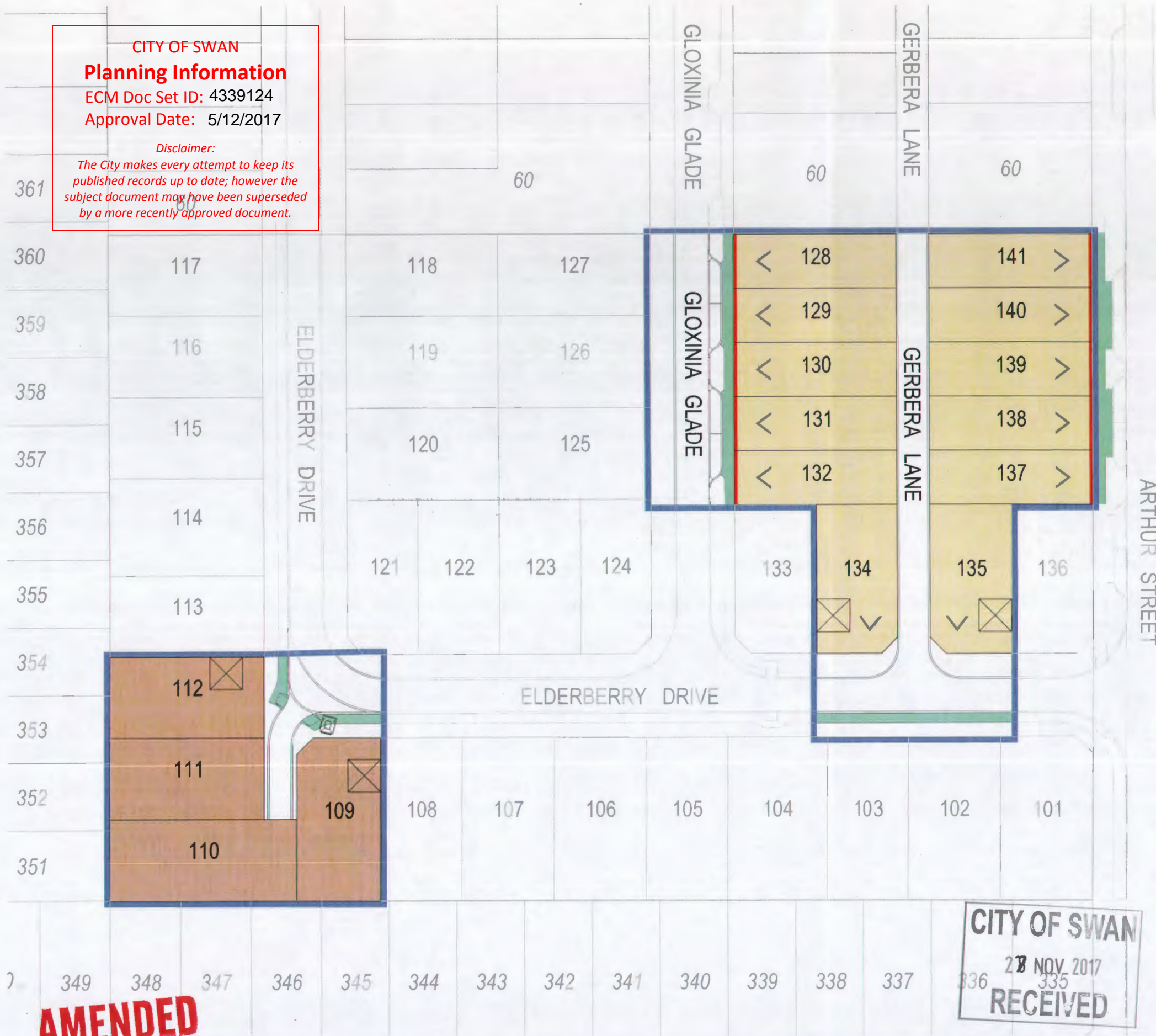

AMENDED